

AREA = 113.184 ACRES OR 4,930,316 SQUARE FEET

CURVE TABLE						
CURVE	DELTA	LENGTH	RADIUS	TANGENT	CHORD	CHORD BEARING
C1	15°33'40"	508.52	1872.36	255.84	508.96	S25°41'37"W
C2	4°21'31"	139.42	1832.76	69.75	139.39	S51°14'06"W
C3	5°38'22"	175.40	1782.00	87.77	175.33	S50°35'41"W

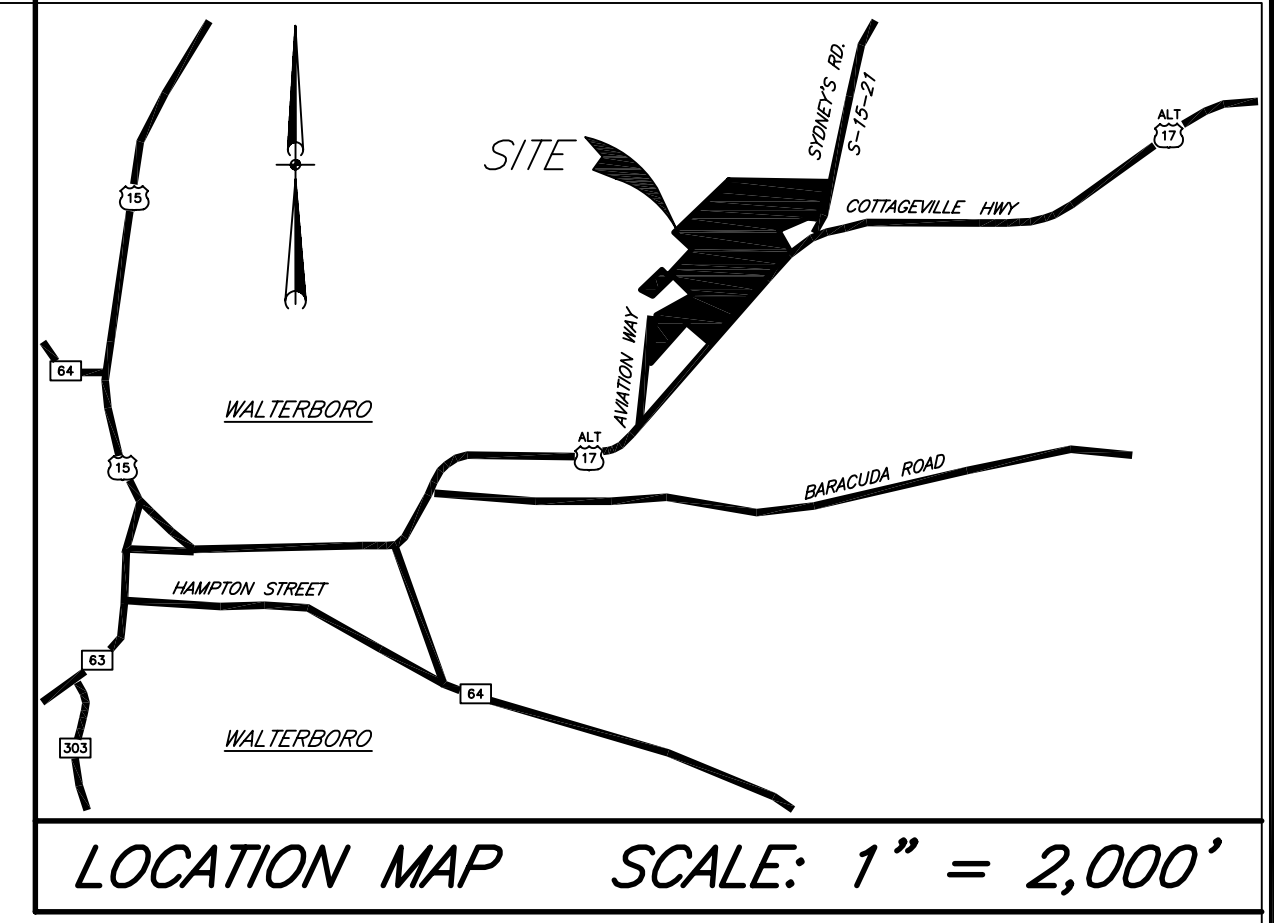
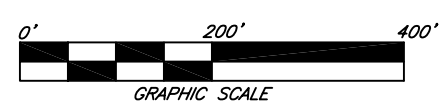

REVISION		
NO.	DESCRIPTION	DATE
1.	RUNWAY AND BUILDING LOCATIONS ADDED	8-14-07

APPROVALS	
PROJECT ENG.	DESIGNED BY:
	SM
DRAWN BY:	CHECKED BY:
SM	RJS/HBD
APPROVED BY:	HBD

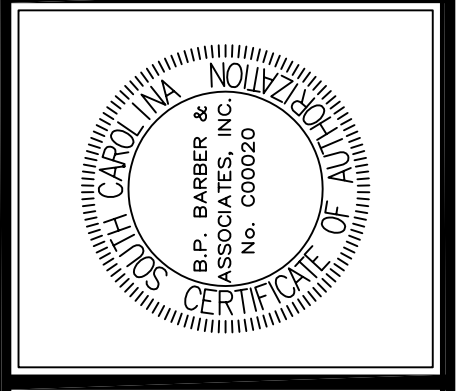

**bpb**  
**BP Barber**  
 Engineering • Experience • Excellence  
 COLUMBIA • SPARTANBURG • CHARLESTON  
 FLORENCE • CHARLOTTE • SAVANNAH

**EXHIBIT MAP**  
 DATE: AUGUST 9, 2007  
 SCALE: 1" = 200'

LOW COUNTRY REGIONAL AIRPORT MULTI-COUNTY PARK, WALTERBORO, S.C.  
 PREPARED FOR COLLETON COUNTY ECONOMIC ALLIANCE, INC.  
 COLLETON COUNTY, S.C.  
 NEAR WALTERBORO

- REFERENCE IS MADE TO THE FOLLOWING:**
- PLAT OF TRACT OF LAND CONTAINING 303 ACRES WHICH IS TO BE LEASED BY WALTERBORO-COLLETON COUNTY AIRPORT COMMISSION TO READE EQUIPMENT COMPANY BY S.S. SNOOK DATED OCTOBER 15, 1951 AND RECORDED IN PLAT BOOK 7, PAGE 99.
  - PLAT OF A PORTION OF WALTERBORO-COLLETON COUNTY AIRPORT COMMISSION BY S.S. SNOOK DATED OCTOBER 15, 1960 AND RECORDED IN PLAT BOOK 10, PAGE 278.
  - PLAT OF FOUR AND ONE-TENTH ACRES SURVEYED FOR WALTERBORO-COLLETON COUNTY AIRPORT COMMISSION BY S.S. SNOOK DATED DECEMBER 19, 1975 AND RECORDED IN PLAT BOOK 16, PAGE 146.
  - PLAT OF A PARCEL OF LAND SITUATED AT ANDERSON FIELD SURVEYED FOR HEIRS OF FRED BRAUNSTEIN BY W. GENE WHITSELL DATED OCTOBER 15, 1984 AND RECORDED IN PLAT BOOK 23, PAGE 128.
  - PLAT SHOWING 5.14 ACRES OF LAND SITUATED AT ANDERSON FIELD FOR FLOYD E. COKER BY B.J. KING DATED JULY 27, 1986 AND RECORDED IN PLAT BOOK 25, PAGE 178.
  - PLAT PREPARED FOR R.L. KANNADAY AND R.L. KANNADAY, JR. BY THOMAS GORDAN MCLEOD DATED JULY 12, 1990 AND RECORDED IN PLAT BOOK 29, PAGE 118.
  - SOUTH CAROLINA DEPARTMENT OF TRANSPORTATION FILE NUMBER 15.2000 SHEETS 6 AND 7.

- NOTES:**
- ANYTHING SHOWN OUTSIDE THE DEFINED BOUNDARY OF THIS PLAT IS FOR DESCRIPTIVE PURPOSES ONLY.
  - THE LOCATION OF ALL UTILITIES SHOWN HEREON ARE APPROXIMATE AND MUST BE VERIFIED BY OPERATING AUTHORITIES PRIOR TO CONSTRUCTION.
  - ALL PROPERTY CORNER SIZES ARE MEASURED TO THE OUTSIDE DIMENSION.
  - THIS PLAT WAS COMPILED FROM REFERENCED PLATS AND ELECTRONICALLY SCANNED FROM COLLETON COUNTY GIS ARIEL MAP.
  - COLLETON COUNTY TAX ASSESSOR'S TAX MAP No. 132-00-00-028.

**FLOOD NOTE**  
 I HAVE EXAMINED THE FLOOD INSURANCE RATE MAP FOR COLLETON COUNTY, SOUTH CAROLINA, COMMUNITY PANEL NUMBER 45029C0320F PANEL 320 OF 731, DATED NOVEMBER 7, 2001 AND HEREBY STATE BY GRAPHIC PLOTTING ONLY THAT THIS PROPERTY IS NOT LOCATED IN THE 100 YEAR FLOOD HAZARD AREA AS DETERMINED BY THE FEDERAL EMERGENCY MANAGEMENT AGENCY.

**COPYRIGHT NOTICE**  
 THIS DRAWING IS THE PROPERTY OF B.P. BARBER & ASSOCIATES, INC. AND IS NOT TO BE REPRODUCED OR COPIED IN WHOLE OR IN PART. IT IS ONLY TO BE USED FOR THE PROJECT AND SITE SPECIFICALLY IDENTIFIED HEREIN AND IS NOT TO BE USED ON ANY OTHER PROJECT.

TWG. NAME 06572.dwg	SHEET 1
T/B. NO. 2112, Pg 43	OF 1
REFERENCE 34,294-G4	
PROJECT NO. 06572-CHS	

FILE NO. 34,294-B82

N:\Projects\06572-CHS\Drawings\LOW COUNTRY AIRPORT.dwg 8/14/2007 5:25:45 PM ET